

# PLAT NO. 4, LOBLOLLY BAY, A P.U.D.

P.U.D. PHASE 11

BEING A REPLAT OF A PORTION OF PARCEL "D", LOBLOLLY BAY, A P.U.D., RECORDED IN P.U.D. PLAT BOOK 1, PAGE 14, AND A PORTION OF LOT 32, GOMEZ GRANT, PLAT BOOK 1, PAGE 80, TOWNSHIP 39 SOUTH, RANGE 42 EAST, MARTIN COUNTY, FLORIDA

NOVEMBER, 1987

SHEET 1 OF 2

**DESCRIPTION**

STATE OF FLORIDA  
COUNTY OF MARTIN

A PARCEL OF LAND LYING WITHIN A PORTION OF PARCEL "D", ACCORDING TO THE PLAT OF LOBLOLLY BAY, A P.U.D., AS RECORDED IN P.U.D. PLAT BOOK 1, AT PAGE 14, IN AND FOR THE RECORDS OF MARTIN COUNTY, FLORIDA, SAID PARCEL ALSO LYING WITHIN A PORTION OF LOT 33, ACCORDING TO THE PLAT OF GOMEZ GRANT, AS RECORDED IN PLAT BOOK 1, AT PAGE 80, IN AND FOR THE RECORDS OF MARTIN COUNTY, FLORIDA, BEING MORE PARTICULARLY DESCRIBED AS FOLLOWS:

BEGINNING AT THE SOUTHWEST CORNER OF PARCEL "D" AFORESAID; THENCE NORTH 13°46'29" WEST, ALONG THE WESTERLY LINE OF SAID PARCEL "D" (THE SOUTH LINE OF SAID PARCEL "D" IS ASSUMED TO BEAR NORTH 66°00'00" EAST AND ALL OTHER BEARINGS ARE RELATIVE THERETO) A DISTANCE OF 195.18 FEET TO A POINT; THENCE NORTH 26°25'29" EAST, CONTINUING ALONG THE WESTERLY LINE OF SAID PARCEL "D", A DISTANCE OF 125.0 FEET TO A POINT LYING ON THE SOUTHERLY RIGHT-OF-WAY LINE OF S. E. LITTLE HARBOUR DRIVE (50' RIGHT-OF-WAY), SAID POINT ALSO LYING ON A CURVE CONCAVE TO THE SOUTHWEST, HAVING A RADIUS OF 414.51 FEET, A CENTRAL ANGLE OF 3°04'31" AND A RADIAL BEARING AT THIS POINT OF SOUTH 26°25'29" WEST; THENCE SOUTHEASTERLY, ALONG SAID SOUTHERLY RIGHT-OF-WAY LINE AND ALONG THE ARC OF SAID CURVE, A DISTANCE OF 22.25 FEET TO THE POINT OF TANGENT OF SAID CURVE, SAID POINT ALSO LYING ON THE SOUTHERLY LINE OF A 50 FOOT INGRESS AND EGRESS EASEMENT; THENCE SOUTH 60°30'00" EAST, ALONG THE SOUTHERLY LINE OF SAID INGRESS AND EGRESS EASEMENT, A DISTANCE OF 203.62 FEET TO A POINT OF CURVE CONCAVE TO THE NORTH, HAVING A RADIUS OF 223.40 FEET AND A CENTRAL ANGLE OF 53°30'00"; THENCE EASTERLY, CONTINUING ALONG THE SOUTHERLY LINE OF SAID INGRESS AND EGRESS EASEMENT AND ALONG THE ARC OF SAID CURVE, A DISTANCE OF 208.60 FEET TO THE POINT OF TANGENT OF SAID CURVE, SAID POINT LYING ON THE SOUTH LINE OF PARCEL "D" AFORESAID; THENCE SOUTH 66°00'00" WEST, ALONG THE SOUTH LINE OF SAID PARCEL "D" AND DEPARTING FROM THE SOUTHERLY LINE OF SAID INGRESS AND EGRESS EASEMENT, A DISTANCE OF 445.40 FEET TO THE POINT OF BEGINNING.

CONTAINING IN ALL 1.26 ACRES, MORE OR LESS.

**CERTIFICATE OF OWNERSHIP AND DEDICATION**

STATE OF FLORIDA  
COUNTY OF MARTIN

S & C REALTY, INC., A FLORIDA CORPORATION, DOES HEREBY CERTIFY THAT IT IS THE OWNER OF THE PROPERTY DESCRIBED HEREON AND HAVE CAUSED THE SAME TO BE SURVEYED AND PLATTED AS SHOWN HEREON AND DOES HEREBY DEDICATE AS FOLLOWS:

- PARCEL "A":**  
PARCEL "A", AS SHOWN HEREON, SHALL BE CONVEYED TO THE OWNER OF LOT 15 OF LOBLOLLY BAY (AS RECORDED IN P.U.D. PLAT BOOK 1, PAGE 14, OF THE PUBLIC RECORDS OF MARTIN COUNTY, FLORIDA) AND SAID PARCEL "A" AND LOT 15 SHALL BE HELD IN SINGLE OWNERSHIP IN PERPETUITY.
- PARCEL "B":**  
PARCEL "B", AS SHOWN HEREON, SHALL BE CONVEYED TO THE OWNER OF LOT 7 OF LOBLOLLY BAY (AS RECORDED IN P.U.D. PLAT BOOK 1, PAGE 14, OF THE PUBLIC RECORDS OF MARTIN COUNTY, FLORIDA) AND SAID PARCEL "B" AND LOT 7 SHALL BE HELD IN SINGLE OWNERSHIP IN PERPETUITY.

SIGNED AND SEALED THIS 1st DAY OF December, 1987,

S & C REALTY, INC.  
A FLORIDA CORPORATION

WITNESS: Paula K. Malone  
WITNESS: E. Manning  
BY: Robert W. Stackler  
ROBERT W. STACKLER  
PRESIDENT

ATTEST:  
WITNESS: K. Patricia Cotton  
WITNESS: E. Lee Cotton  
BY: E. Lee Cotton  
E. LEE COTTEN  
SECRETARY/TREASURER

**ACKNOWLEDGEMENT**

STATE OF FLORIDA  
COUNTY OF MARTIN

BEFORE ME PERSONALLY APPEARED ROBERT W. STACKLER AND E. LEE COTTEN, TO ME WELL KNOWN, AND KNOWN TO ME TO BE THE PERSONS DESCRIBED IN AND WHO EXECUTED THE FOREGOING INSTRUMENT AS PRESIDENT AND SECRETARY/TREASURER OF S & C REALTY, INC., A FLORIDA CORPORATION, AND ACKNOWLEDGED TO AND BEFORE ME THAT THEY EXECUTED SUCH INSTRUMENT AS SUCH OFFICERS OF SAID CORPORATION, AND THAT THE SEAL AFFIXED TO THE FOREGOING INSTRUMENT IS THE CORPORATE SEAL OF SAID CORPORATION AND THAT IT WAS AFFIXED TO SAID INSTRUMENT BY DUE AND REGULAR CORPORATE AUTHORITY, AND THAT SAID INSTRUMENT IS THE FREE ACT AND DEED OF SAID CORPORATION.

WITNESS MY HAND AND OFFICIAL SEAL THIS 1st DAY OF December, 1987.

MY COMMISSION EXPIRES:  
3-31-88

Shirley Lyders  
NOTARY PUBLIC

**TITLE CERTIFICATION**

STATE OF FLORIDA  
COUNTY OF MARTIN

I, STEPHEN FRY, A DULY LICENSED ATTORNEY IN THE STATE OF FLORIDA DO HEREBY CERTIFY THAT I HAVE EXAMINED THE TITLE TO THE HERON DESCRIBED PROPERTY; THAT I FIND THE APPARENT RECORD TITLE TO THE PROPERTY IS VESTED TO S & C REALTY, INC., A FLORIDA CORPORATION, WHO EXECUTED THE CERTIFICATE OF OWNERSHIP AND DEDICATION HEREON; THAT THE CURRENT TAXES HAVE BEEN PAID; AND THAT I FIND THAT THERE ARE NO MORTGAGES.

DATE: NOVEMBER 10, 1987  
AT 5:20 P.M.

Stephen Fry  
STEPHEN FRY, ATTORNEY AT LAW  
FRY & OLENICK, P.A.  
900 EAST OCEAN BOULEVARD, SUITE 120  
STUART, FLORIDA 34994

**SURVEYOR'S CERTIFICATION**

STATE OF FLORIDA  
COUNTY OF MARTIN

THIS IS TO ATTEST THAT THE PLAT SHOWN HEREON IS A TRUE AND CORRECT REPRESENTATION OF A SURVEY MADE UNDER MY RESPONSIBLE DIRECTION AND SUPERVISION AND THAT SAID SURVEY IS ACCURATE TO THE BEST OF MY KNOWLEDGE AND BELIEF AND THAT (P.R.M.'S) PERMANENT REFERENCE MONUMENTS AND (P.C.P.'S) PERMANENT CONTROL POINTS HAVE BEEN PLACED AS REQUIRED BY LAW AND FURTHER THAT THE SURVEY DATA COMPLIES WITH ALL THE REQUIREMENTS OF CHAPTER 177 FLORIDA STATUTES, PART 1, AS AMENDED, AND ORDINANCES OF MARTIN COUNTY, FLORIDA

DATE: 11/6/87

Kenneth L. Scrape  
KENNETH L. SCRAPE  
PROFESSIONAL LAND SURVEYOR  
FLA. CERTIFICATE NO. 2832

**COUNTY APPROVAL**

STATE OF FLORIDA  
COUNTY OF MARTIN

THIS PLAT IS HEREBY APPROVED, BY THE UNDERSIGNED, ON THE DATE, OR DATES INDICATED.

11-16-87  
DATE

BY: Small E. Zellman  
COUNTY ENGINEER

November 3, 1987  
DATE

BY: Allen S. Dreyer  
COUNTY ATTORNEY

November 3, 1987  
DATE

PLANNING AND ZONING COMMISSION  
MARTIN COUNTY, FLORIDA  
BY: Gay C. Young  
CHAIRMAN

November 3, 1987  
DATE

BOARD OF COUNTY COMMISSIONERS  
MARTIN COUNTY, FLORIDA  
BY: W. J. ...  
CHAIRMAN

ATTEST:

BY: Marsha Stiller  
CLERK  
By Deborah Langston

I, MARSHA A. STILLER, CLERK OF THE CIRCUIT COURT OF MARTIN COUNTY, FLORIDA, HEREBY CERTIFY THAT THIS PLAT WAS FILED FOR RECORD IN PLAT BOOK 11, PAGE 5, MARTIN COUNTY, FLORIDA, PUBLIC RECORDS, THIS 12 DAY OF January, A.D., 1987.

MARSHA A. STILLER, CLERK  
CIRCUIT COURT  
MARTIN COUNTY, FLORIDA

BY: Deborah Langston  
DEPUTY CLERK

FILE NO.: 691870

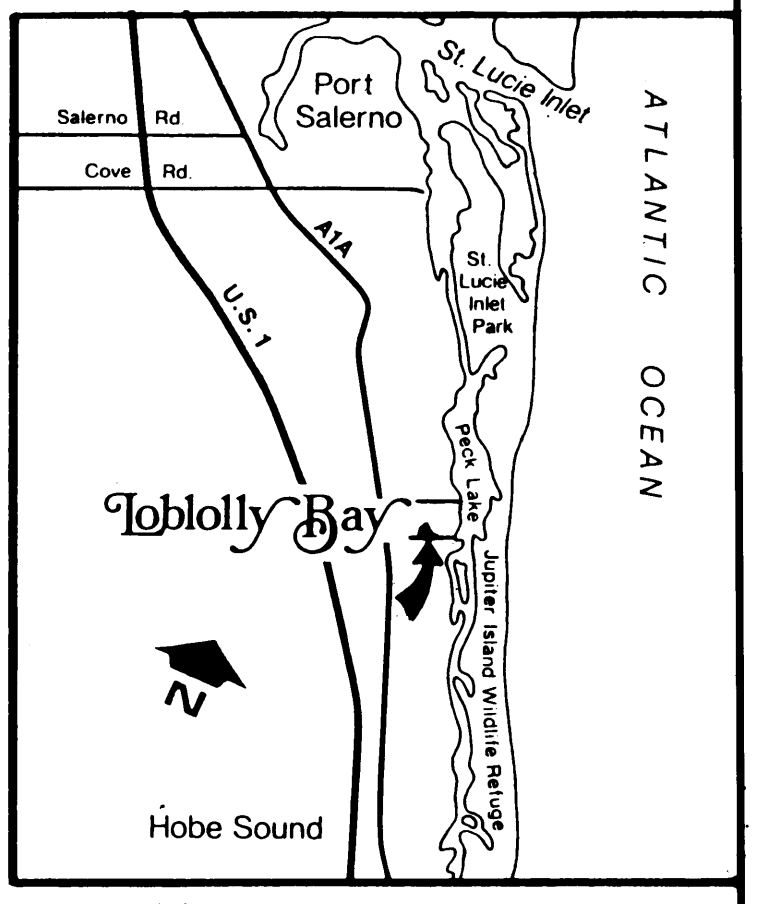
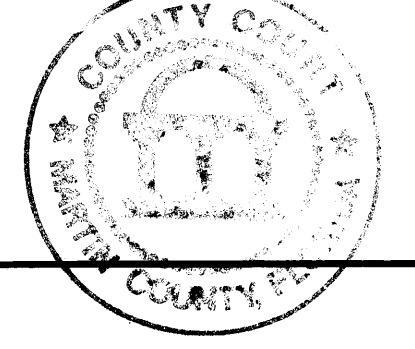

THIS INSTRUMENT PREPARED BY KENNETH L. SCRAPE, AT THE OFFICE OF KENNETH L. SCRAPE, INC., PROFESSIONAL LAND SURVEYORS, 11380 PROSPERITY FARMS ROAD, SUITE 109, PALM BEACH GARDENS, FLORIDA 33410

Subdivision Parcel Control #: 34-38-42-163-000-0000-0

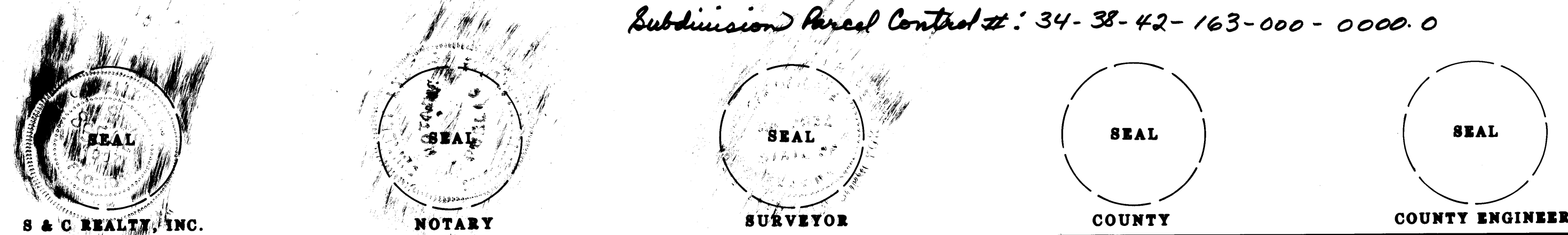

PLAT OF			
PLAT NO. 4, LOBLOLLY BAY, P. U. D.			
KENNETH L. SCRAPE, INC.			
PROFESSIONAL LAND SURVEYORS			
PALM BEACH GARDENS, FL., PH: 305-627-3401			
FIELD: J.O.	OFFICE: K.S.	CK'D: K.S.	
JOB NO: JB70561	DATE: AUGUST, 1987	DWG. NO: CB7-834	
JF: 7 DC: 7	FB: MC3 PG: 48	SHEET 1 OF 2	